

Disabled and Sexy – Alter State Closing Party

Presented by Arts Centre Melbourne – Alter State,
Melbourne Fringe and Arts House

Access Guide



Image: courtesy of Kitty Obsidian, Photo by Joel Devereux

Description: Image of a fat Aboriginal femme presenting person. They are wearing pink leopard print costume and holding a whip high above their head. Long plait of hair hanging down their body and drag makeup with pink, blue and purple lighting.

Updates to this document

Please note, this event contains new performances and changes are being made by artists until opening. We will endeavour to provide the latest access information to ticket holders across key stages. Arts House website will contain the most up to date version of this document and all ticket holders will be notified of any revisions made 3 days and 1 day prior to the event.

This document was created: 26 September 2024

Contents

Updates to this document	1
Where	3
When	3
Access Services	3
Co-Hosts and Performers	5
Event Overview	7
Sensory Elements	9
Supper Room, Basement	9
Social Space, Level 1	10
Outdoor Terrace, Level 1	11
Audience Experience	12
Entry to spaces	12
Shocks or surprises	15
Audience expectations	15
Social expectations	15
Performance expectations	17
Other	17
The Venue	18
Event Entrance	18
Box Office	19
Ushers	20
Bar	21
Quiet Space	22
Bathrooms	22
Lift	23
Transport	24
Tram	24
Train	24
Bus	24
Parking	24
COVID Safety	25

Where

Arts House

521 Queensberry Street

North Melbourne VIC

This event will take place across 3 levels of the building, see details below.

When

Saturday 12 October, 8:30pm

Duration: 3.5 hours

Running order for acts and DJs can be found below.

Access Services



This is a bilingual event presented in English and Auslan. Social interpreters available throughout the event and on stage.



Personal describer guides available for meet & greet on arrival and one-on-one live descriptions of the performance. This service must be pre-booked by 4 October.



Tactile Tour - An optional Tactile Tour will be available at the start of the event. This service must be booked by 4 October.



Assistance Animals are welcome.



Visual Rating 50% – this event has music and sounds.



This performance is fully wheelchair accessible. Information about accessible entrances and bathrooms can be found below.



Quiet Space Available - The quiet space will be available for you to use during the event. More information about the quiet space can be found later in this guide.



Companion Card - Arts House supports the Companion Card program.

Co-Hosts and Performers



Co-Host: Mademoiselle Coco



Co-Host: Jodee Mundy



Performer: Sam Martin



Performer: Nathan Borg



Performer: Sarah Birdgirl



Performer: Thomas Banks



Performer: Naavikaran



Performer: Kitty Obsidian



DJ: KIN



DJ: Aquenta

Event Overview

This event will take place across three levels of Arts House.

- **Basement Level**, Supper Room – main party room, DJs and performances
- **Ground Level**, Reception – artwork by Amy Claire Mills and Quiet Space
- **Level 1** – Chill out space with artwork by Amy Claire Mills and open-air terrace

All spaces are accessible by lift and stairs.

Doors to all event spaces will open at **8:30pm**, including the social space and outdoor terrace. They will close at **12:30am**.

Tactile Tours will also begin at **8:30pm** for anyone who has registered.

COVID Safety

This is a mask friendly event. HEPA Air Purifiers, complimentary N95 masks and open-air terrace will be available. Please see COVID safety plan below.

Warnings

This event contains sustained loud music, coarse language, crowds, some partial nudity, lights that change in colour and intensity.

Main Party Room Running Order

8.30pm KIN DJ Set

9.00pm Acknowledgement of Country & Intro act from the Hosts - Mademoiselle
Coco and Jodee Mundy
Performance by Thomas Banks
KIN DJ Set
Performance by Sam Martin and Nathan Borg

10.00pm Disabled & Sexy Competition led by Mademoiselle Coco and Jodee Mundy

10.30pm Aquenta DJ Set
Performance by Sarah Birdgirl
Aquenta DJ Set
Performance by Naavikaran
Performance by Kitty Obsidian

11.30pm Aquenta DJ Set & Last drinks

12.00am Farewell act by Mademoiselle Coco and Jodee Mundy

12.30am Doors close across venue

Sensory Elements

Supper Room, Basement

- **Sound:** There will be consistent sound throughout the event. This includes performances, singing, MC dialogue and dance music. The music will occasionally fade in and out across the night and between performance acts. At times the music might be quite loud. At times the performers and Auslan interpreters may be voicing over music or background noise. There will also be talking and noise from party guests attending.
- **Lighting:** Coloured lighting that may fade between different warm and cool tones and go onto the stage, and into the room on the audience. Each act will have a different lighting state. Sometimes the stage may be bright spotlight or wash and the lights on the audience will go low. There is no projection or screens in the space. There will be no strobes or flashing lights.
- **Physical:** Vibration will be felt from the music. There may be potential for physical interaction between the audiences as everyone can freely move around throughout the event. At times, performers may be roving in the party space during their acts. There will be Air Purifiers in the space and air conditioning so you might feel moving air on your skin. The floors are smooth and flat surface.
- **Smell:** There is no use of scent in the party or any acts.
- **Visual:** There will be a bar in the space, a small 4m x 3m stage, and DJ equipment. The stage will have a red velvet backdrop and tinsel curtain. Performers will use an assortment of props for their acts including: a whip, flowers,

angel grinder, bed of nails, hoola hoop, and a light writer. One of the performers will be dressed up in a cocoo costume.

Social Space, Level 1

- **Sound:** Ambient music will play in this space and the sound of people chatting.
- **Lighting:** The lighting in the social space upstairs will be soft mood lighting.
- **Physical:** The social space upstairs will contain a range of soft furnishings, beanbags and soft sculpture artworks that can be touched and interacted with. This includes two large glove shaped textile works with pillows which patrons can physically get into a lay down in. The terrace is outdoors and has no cover from the natural environment and weather.
- **Smell:** There is no use of scent in this space.
- **Visual:** A series of Amy's soft sculptural artworks will be installed in this space. These soft sculptures replace traditional medical tools, subverting established medical environments' cold and sterile nature.

There are two large body-sized medical gloves with accompanying pillows. You are welcome to physically get inside these gloves and lay down. The inside of both gloves is lined with soft velvet.

An assortment of medical tools, including a thermometer, pills, and pill bottles, will be placed around the space. You're welcome to touch these items, cuddle them, or rest on them gently. Each piece is handmade and not designed for heavy use, so

please don't throw or jump on them. You can use the pills as a stimming tool, but they must stay in the studio.

A large circular quilt will be hung in the space and can be viewed from both sides. Each side features different colours, materials, and phrases. This artwork cannot be touched.

Please see Soft Connections Access Guide for detailed information. [PDF](#) | [Word](#)

Outdoor Terrace, Level 1

- **Sound:** There may be ambient sound and street noise.
- **Lighting:** There are several strings of light globes elevated in this space as well as four outdoor lights that provide an ambient glow. You may also see streetlights as the terrace is above George Johnson Lane.
- **Physical:** This is an open-air terrace, you may feel the elements on your skin.
- **Smell:** You may smell some of the herbs in the planter boxes or other ambient scents that the wind carries from the street and surrounding buildings.
- **Visual:** The courtyard has planter boxes, and an assortment of outdoor chairs and tables.

Audience Experience

Entry to spaces

Supper Room, Basement Level

The main party room is located in the Supper Room in the Basement.



Description: view of Supper Room from main doorway. We can see 3 concrete pillars, evenly spaced across the parquetry floor. There is a table with chairs surrounding it in the middle of the room.

Access to the space:

- The Supper Room can be accessed either via lift or stairs from the foyer area.
- There are 20 stairs to the Supper Room with grab rails either side. Please note - the staircase is wide, so grab rails are not able to be used on both sides at the same time. The staircase also has a low archway, so please be alert to ensure you avoid injury.
- Entry to Supper Room is through a glass door which is 150cm wide

Terrace, Level 1

The outdoor Terrace will be open for people to get fresh air and socialize.



Description: view of balcony terrace from ramp. We can see tables and chairs, planter boxes and strings of lights in the air. There are surrounding brick buildings nearby.

Access to the space:

- The terrace can be accessed either via lift or stairs from the foyer area.
- The stairs to Level 1 have grab rails on either side. Please note - this staircase is very wide, so grab rails are not able to be used on both sides at the same time.

Social Space, Level 1

The social space includes artwork by Amy Claire Mills and an assortment of bean bags.



Image: a photo of Studio 1, looking from the doorway into the room. The floors are polished hardwood and black drapes separate three windows with natural light streaming through, on the opposite side of the room.

Access to the space:

- Studio 1 can be accessed either via lift or stairs from the foyer area.
- The stairs to Level 1 have grab rails on either side. Please note - this staircase is very wide, so grab rails are not able to be used on both sides at the same time.

Shocks or surprises

Sarah Birdgirl will operate an angle grinder in her act and lay on a bed of nails. Kitty Obsidian's act involves cracking a flower with a whip that is positioned between their assistant's hand, mouth and legs. Thomas Banks act involves inviting someone from the audience to operate his communication device.

Audience expectations

Sam Martin and Nathan Borg's act will commence on the dance floor amongst audience members and they may be in close proximity to you.

All other acts will take place on the stage, and audiences can choose to experience the performances from any distance that is comfortable.

Social expectations

Audiences are able to move freely around the space and across all levels. The DJs will play dance music in the Supper Room between each act, and you are welcome to dance in the space or socialise.

There will be a small number of high and low tables and chairs available in the Supper Room, and relaxed spaces in the foyer. The social space upstairs will have an assortment of bean bags and interactive artworks.

You are welcome to come and go as you please across all spaces, make noise, stim, and respond to the work for the duration of the event.

There is an optional dress-up competition all guests are welcome to take part in. Guests are invited to come to the party dressed up according to the four categories below.

Maybe you're feeling a little tactile or want to put your most sassiest outfit on. Or perhaps you'd rather blend into the crowd.

This will be hosted by the MCs Mademoiselle Coco and Jodee Mundy and involve coming up on stage for a short moment.

Categories are:

Best Textured

You're the most tactile person in the room, you're irresistible to touch

Armour Against Ableism

You're a hero of community, nothing's going to get you down

Sexy Disabled Pride

You're the epitome of sass and so hot you've got your own #hashtag

Ally

You know it's not about you, but you always show up

No pre-registration is required to enter the competition.

It will commence at 10pm and winners take home an original print by Luke Duncan King.

Performance expectations

During the performances, the co-hosts will introduce the artists and their acts. The co-hosts themselves will have an intro act and outro act. Thomas Banks performance involves a moment of invited interaction from one audience member. All other acts do not include interactive elements. The dress-up competition is optional and will involve a moment of coming up on stage and fashioning your outfit.

Other



Alter State Evaluator: David Ralph

Come "Say Hi" to David Ralph (Auslan-CODA), Alter State's Evaluation Facilitator. David is here to gather feedback from audiences about their festival experience. Spot David at Disabled and Sexy Party and share your thoughts with him!

The Venue



Description: North Melbourne Town Hall features giant red letters that say ARTS HOUSE out the front of it.

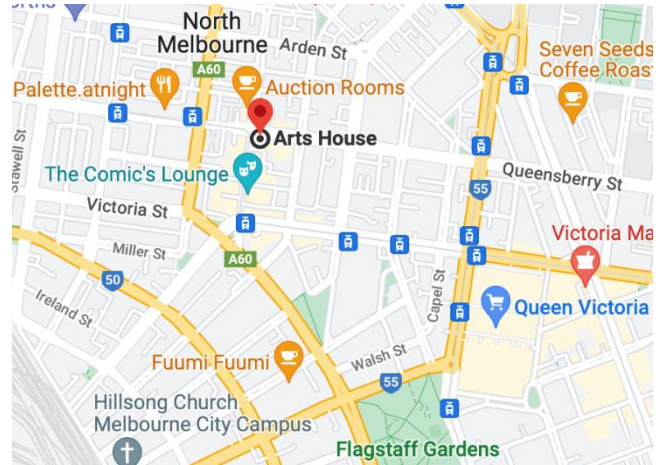

Description: a map of Arts House and its surrounding area. [LINK TO MAP](#)

Event Entrance



The main party entrance is via George Johnson Lane from Errol Street, North Melbourne. This entrance is wheelchair accessible and has grab rails either side.



Image: View of George Johnson Lane from Errol St. The laneway passes through an archway with a brick wall at the end.

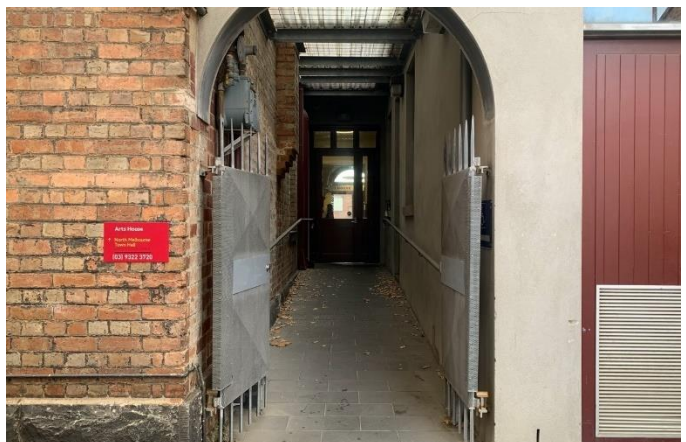

Image: view of the ramp leading from George Johnson Lane to the automated door which opens into the Arts House foyer.

Box Office



Description: an image of reception welcome desk showing one of our receptionist's waving and smiling. To the left of the reception desk is the main staircase, showcasing some artwork on the walls.

The Box Office is located in the foyer under the stairwell.

Ushers



Ushers will be wearing black with an Arts House Logo on the left hand shoulder.

Bar



Description: A bar with vases on each side of the bench filled with native flowers. In the centre there is a bar menu displayed with drinks set up on the top level on the bar. Towards the back wall there is an Arts House sign that is lit up. The lighting of the space is lit up orange.

Bar staff will be wearing black with an Arts House Logo.

We have a range of alcoholic and non-alcoholic beverages for sale.

We are a cashless venue and accept EFTPOS, Visa and Mastercard payments.

Quiet Space



Arts House Quiet Space is located on Ground Level and is nearby reception and opposite the accessible bathrooms. It includes a range of seating options including soft furnishings, dimmable lights, sensory and stim objects. It is open during venue opening hours and events as a quiet space, prayer or parenting space.



Description: Quiet space with lights dimmed assortment of soft chairs and central table



Description: Quiet space kitchenette with water cooler

Bathrooms

All bathrooms have Dyson hand dryers with sensor activation. There is an accessible bathroom that is single use on ground level opposite the Quiet Space. There is another accessible bathroom upstairs – this is accessible via lift or stairs.

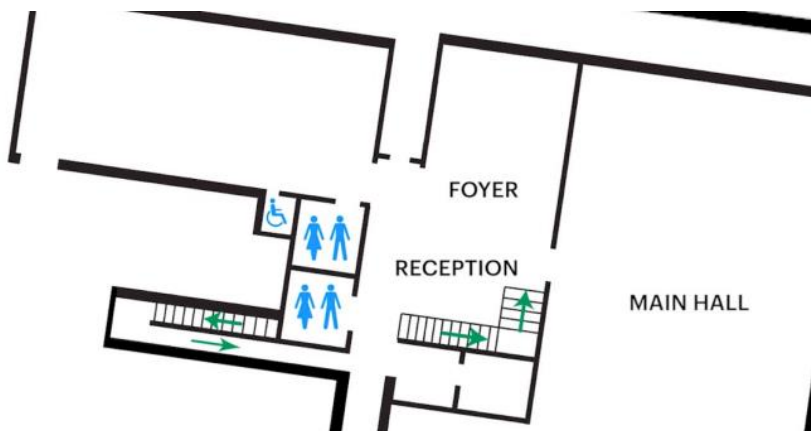

Lift

The lift is located behind reception desk in the foyer.

The closest entry to the lift is via George Johnson Lane.



Description: external view of the lift from the ground floor foyer. The lift has silver metal automated doors and a button mount to the right of the doorframe.

Transport

Tram

Route 57 (High Floor trams only)

Stop 12, North Melbourne Town Hall.

Please note, this is not a wheelchair accessible tram

[GETTING TO ARTS HOUSE VIDEO LINK](#)

Train

Arts House is 1.1km from

North Melbourne Train Station,

approximately 16 minute walk

[North Melbourne Station Information](#)

1.2km from Flagstaff Station,

approximately 15 minute walk

[Flagstaff Station Information](#)

Bus

Bus number: 216

Parking

There is limited paid on-street parking on Queensberry Street and Errol Street.

There are two accessible on street car parking spaces on Queensberry Street (150m to our accessible Errol Street entrance) for holders of a Parking Permit for Disabled people.

COVID Safety

Please note: If you have a cough, sore throat, fever, shortness of breath or flu-like symptoms, you must not attend our venue or programs in person.

We will provide a refund if you need to cancel your attendance due to illness. Please contact us by 9am on the day of the event.

To minimise the risk of COVID-19 transmission, we advise all patrons, artists and staff to:

- Practise physical distancing where possible
- Practise good hygiene by washing and or sanitising your hands often
- Wear a mask as directed by Victorian Government guidelines

Throughout this event you will find:

- hand sanitiser stations available
- complimentary N95 masks
- open-air terrace
- 2x Levoit Core 600S Smart True HEPA Air Purifiers in Supper Room

We also ensure that spaces are well ventilated.

Staying COVID-safe remains important. We must all follow these steps:

- Follow the Victorian Government's measures on how to stay safe.
- When you cannot safely socially distance it is recommended to wear a well fitted mask
- Practise COVID-safe hygiene protocols.